

State of Wyoming Corner Record

(In compliance with the CORNER PERPETUATION AND FILING ACT, Wyoming Statutes, 1977, Section 36~11~101, et seq., and the Rules and Regulations of the Board of Registration for Professional Engineers and Professional Land Surveyors)

The reverse side of this form may be used if more space is needed.

The Record of the original survey and the citation of the source of the historical information (if the corner is lost or obliterated). The description of the corner monumentation evidence as found and/or the monument and it's accessories as established to perpetuate the location of this corner. A sketch of the relative location of this Monument, accessories, and reference points with the course and distance to adjacent corner (s) (if determined during this Survey). The Method and Rationale used for the reestablishment of lost and obliterated corner.

GLO: Survey performed by Edwin James, Deputy Surveyor, under joint contract with Alfred M. Rogers, contract Number 15; Contract let 20 May 1871, project complete 16 June 1871.

"East on a Random line between Sections 17 & 20, [Variation 15.35'E] Measure 40.00 chains set Temporary 1/4 corner; 80.65 chains, intersect N~S line 16 links S of the corner to sections 16,17,20 & 21 from which corner I run S89°53'W on a true line between Sections 17 & 20 a distance of 40.32 1/2 chains and set a sandstone 16"X12"X5" for 1/4 corner,"

Set 2"X32" iron pipe with 3" Aluminum Cap equidistant from the corner common to 17,18,19 & 20 and the corner common to Section 16,17,20 & 21.

Set 2"X32" iron pipe with 3 1/2" Aluminum Cap

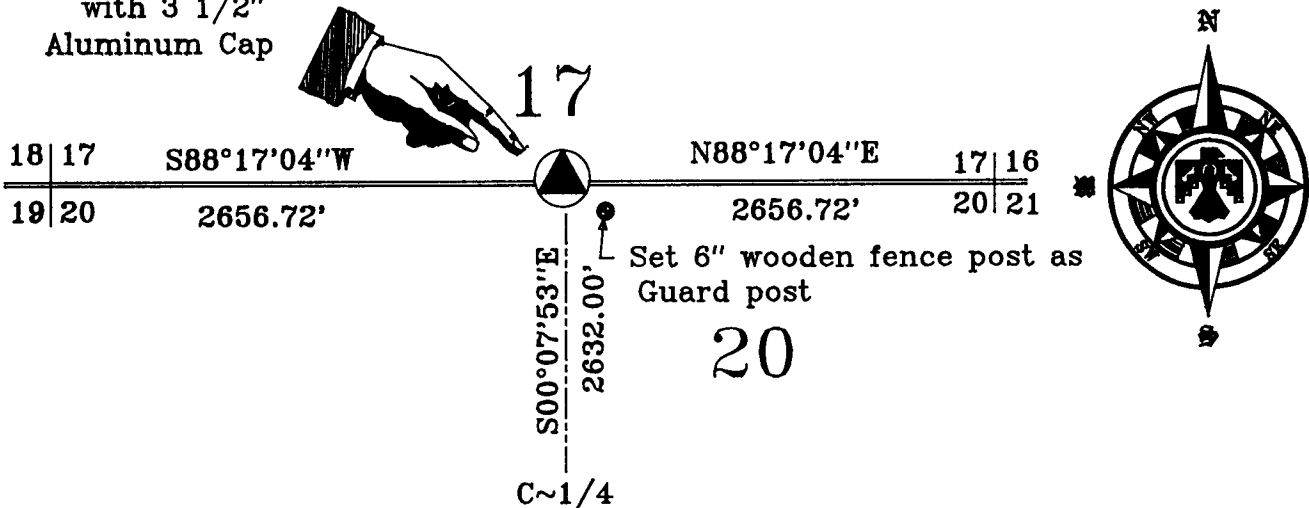

1999 JUN 29 AM 11:56  
LARAMIE COUNTY CLERK  
CHEYENNE, WY.

255192

Date of Field Work: June A.D. 1999 Office Reference: Open Trails Est. 9030

Cross Index Diagram

T.14 N. R.63 W. 6th P.M.

	1	2	3	4	5	6	7	8	9	10	11	12	13	14	15	16	17	18	19	20	21	22	23	24	25
A																									
B																									
C																									
D																									
E																									
F																									
G																									
H																									
I																									
J																									
K																									
L																									
M																									
N																									
O																									
P																									
Q																									
R																									
S																									
T																									
U																									
V																									
W																									
X																									
Y																									
Z																									

Firm/Agency, Address  
Terrestrial Surveying & Mapping Co.  
"Your Friendly Neighborhood Surveyor"  
1127 Terry Ranch Road  
Cheyenne, Wyoming 82007  
Telephone Number: (307) 634~9360

This Corner Record was prepared by me or under my direction and supervision.

SEAL & SIGNATURE



Corner Name: 1/4 Section: 17/20 T.14 N. R.63 W. 6th P.M. Cross Index No.

N~7